

Sixty-Third Annual Meeting
of the
Southeastern Division of the Association of
American Geographers



Hosted by:

The University of North Carolina-Greensboro

**Greensboro Marriott Downtown
Greensboro, NC**

November 22-25, 2008

SEDAAG EXECUTIVE COMMITTEE

President: **Derek Alderman, East Carolina University**
Vice President: **Russ Ivy, Florida Atlantic University**
Treasurer: **Katie Algeo, Western Kentucky University**
Secretary: **Hilda Kurtz, University of Georgia**
Councillor: **Doug Gamble, UNC-Wilmington**
Past President: **Gerald Webster, University of Wyoming**

SEDAAG STEERING COMMITTEE

Members of the Executive Committee (see above)

Editors, *Southeastern Geographer*, **Robert Brinkmann** and **Graham Tobin, University of South Florida**

State Representatives:

Alabama: **Lisa Davis, University of Alabama**
Florida: **Lisa Jordan, Florida State University**
Georgia: **Doug Oetter, Georgia State College and University**
Kentucky: **Scott Dobler, Western Kentucky University**
Mississippi: **John Rogers, Mississippi State University**
North Carolina: **Dan Royall, University of North Carolina-Greensboro**
South Carolina: **Diansheng Guo, University of South Carolina**
Tennessee: **Esra Ozdenerol, University of Memphis**
Virginia: **Johnathan Walker, James Madison University**
West Virginia: **Ann Oberhauser, West Virginia University**

SEDAAG 2008 LOCAL ARRANGEMENTS COMMITTEE

D. Gordon Bennett, UNC-Greensboro

Jeffrey Patton, UNC-Greensboro

SEDAAG 2008 PROGRAM COMMITTEE

Russ Ivy, Chair, Florida Atlantic University
Derek Alderman, East Carolina University
Mary Caravelis, Barry University
Greg Carbone, U. of South Carolina
Thomas Chapman, Georgia Southern U.
Sharon Cobb, U. of North Florida
David Cochran, U. of Southern Mississippi
Michael Crutcher, U. of Kentucky
Scott Curtis, East Carolina University
Maria Fadiman, Florida Atlantic U.
Mary Finley-Brook, U. of Richmond
Jackie Gallagher, Mary Washington U.
Bill Graves, UNC-Charlotte
Peggy Gripshover-U. of Tennessee
James Henry, Middle Tennessee State

Chip Konrad-UNC-Chapel Hill
Jerry Mitchell, U. of S. Carolina
Joe Nicholas, Mary Washington U.
Ann Oberhauser, West Virginia U.
Ray Oldakowski, Jacksonville U.
Jennifer Rahn, Samford U.
Charles Roberts, Florida Atlantic
John Rogers, Mississippi State
Wei Song, U. of Louisville
Tim Warner, West Virginia U.
Bobby Wilson, U. of Alabama
Zhixiao Xie, Florida Atlantic U.
Xiaobai Yao, U. of Georgia
Rob Yarbrough, Georgia Southern

OFFICERS, ASSOCIATION OF AMERICAN GEOGRAPHERS

President: **John A. Agnew, University of California, Los Angeles**
Vice President: **Carol Harden, University of Tennessee**
Secretary: **Craig Colten, Louisiana State University**
Treasurer: **Sallie Marston, Arizona State University**
Past President: **Thomas J. Baerwald, National Science Foundation**
Executive Director: **Douglas Richardson, Association of American Geographers**

SEDAAG HONORS COMMITTEE

Joby Bass, Chair, University of Southern Mississippi
Ross Meentemeyer-Chair Elect (2009) UNC-Charlotte
Jennifer Arrigo, East Carolina University
Paul Gares, East Carolina University
Selima Sultana, UNC-Greensboro

WORLD GEOGRAPHY BOWL COMMITTEE

Laurence W. Carstensen, Chair, Virginia Tech
Jay Lennartson, UNC-Greensboro
Thomas Bell, University of Tennessee
Thomas Deaton, Dalton State College
Dennis Edgell, UNC at Pembroke
Kelly Gregg, Jacksonville State University
Perry Gripshover, University of Tennessee
Elizabeth Leppman, Writer, Map and Book Editor
David Miller, National Geographic Society
Jeffrey Neff, Western Carolina University
Thomas Ross, UNC – Pembroke
Donald Yow, Eastern Kentucky University
Harry Trendell, Kennesaw State University

PROGRAM AT A GLANCE

Saturday, November 22, 2008

1:00pm - 5:00 pm	Early Registration	Mezzanine Level
2:00 pm – 5:30 pm	World Geography Bowl	
	Committee Meeting	Triad East
	<i>(WGB Committee Members Only)</i>	

Special Events and Field Trips

12:00 pm – 6:00 pm **Physical Field Trip-Hanging Rock State Park (\$25)**
Michael Lewis and Dan Royall, UNC-Greensboro
Meet at Marriott Entrance

1:00pm – 5:00pm Geocaching Exercise – UNC-Greensboro Area (free)
 Beth Walton, UNC-Greensboro
Meet behind Graham Building at UNC-Greensboro

Sunday, November 23, 2008

<u>Event/Time</u>	<u>Description</u>	<u>Location</u>
<i>SEDAAG Registration and Information</i>		
7:30 am – 8:00 pm	Registration	Mezzanine Level
11:30 am – 1:00 pm	World Geography Bowl	
	Registration	Mezzanine Level
2:00 pm – 5 pm	Exhibits	Ballroom Foyer

Special Events and Field Trips

8:30am	5K Run (\$10) Jay Lennartson, UNC-Greensboro <i>Meet in Marriott Lobby</i>	
9:00am – 6:00pm	Vineyard Van-Wine Tasting (\$45) Cathy Cole, UNC-Greensboro <i>Meet at Marriott Entrance</i>	
1:00pm – 5:00pm	Urban Field Trip (\$15) Keith Debbage, UNC-Greensboro <i>Meet at Marriott Entrance</i>	

Business Meetings

8:00am-10:00am	Executive Committee	
	Breakfast Meeting	Appalachian
11:00 am - 5:00 pm	Steering Committee Meeting	Appalachian

World Geography Bowl Events

1:00 to 1:30 pm	Orientation	Triad Central
1:30 pm - 5:30 pm	Round Robins	
	Triad Central, Triad West, Triad East, Kitty Hawk, Blue Ridge, Cape Fear	
5:30 pm - 6:00 pm	Announcement of winning teams and formation of All-star team	Triad Central

Event Organizers: World Geography Bowl Committee, chaired by
Laurence W. Carstensen, Virginia Tech

Welcoming Reception

9:30 pm - 11:00 pm Food and Cash Bar

Summit Room

Day 2

Monday

November 24, 2008

Committee on the Status of Women in Geography Meeting

7:00 am - 8:00 am

Breakfast Meeting

Contact Ann Oberhauser

SEDAAG Registration and Information

7:30 am – 5:00 pm

Registration

Mezzanine Level

Special Events and Field Trips

10:15am – 1:15 pm

Walking Historic Field Trip

Dorothy Mason, NC A&T State

Meet at Marriott Entrance

Exhibits

8:00 am – 5:00 pm

Vendors & Departments

Ballroom Foyer

Paper, Poster and Panel Sessions

Location

8:00 – 10:00 am	Session 2:	Student Honors I	Triad East
8:00 – 10:00 am	Session 3:	Legacies of Racial Violence in the U.S. South	Blue Ridge
8:00 – 10:00 am	Session 4:	Honoring Stanley D. Brunn	Triad West
8:00 – 10:00 am	Session 5:	New Voices in SEDAAG I: Physical Geography	Kitty Hawk
8:00 – 10:00 am	Session 6:	Applications in GIScience I	Triad Central
8:00—10:00am	Session 7:	Economic/Development Geog I	Appalachian
8:00 – 10:00am	Session 8:	Hurricane Prediction/Impacts	Cape Fear
9:00 – 12:00 am	Session 9:	Poster Display Session II <i>(authors will be at posters from 9:30 to 11:00)</i>	Ballroom Foyer
10:15 – 12:15 pm	Session 10:	Student Honors II	Triad East
10:15 – 12:15 pm	Session 11:	Local Government Boundary Change in NC	Blue Ridge
10:15 – 12:15pm	Session 12:	Presidential Session: Southern Studies	Triad West
10:15 – 12:15 pm	Session 13:	New Voices in SEDAAG II: Human Geography	Kitty Hawk
10:15 – 12:15 pm	Session 14:	Applications in GIScience II	Triad Central
10:15—12:15pm	Session 15:	Biogeography I	Cape Fear
10:15 – 12:15 pm	Session 16:	Social and Cultural Networks, Flows and Spaces	Appalachian
12:15 – 1:15 pm		LUNCH	

12:15 – 1:15 pm		SEDAAG Honors Committee Meeting	
1:15 - 3:15pm	Session 17	Active Learning Swapshop I	Blue Ridge
1:15 – 3:15pm	Session 18:	Newcomers, New Energy, New Jobs, NASCAR in NC	Appalachian
1:15 – 3:15 pm	Session 19:	Climate I	Triad Central
1:15 – 3:15 pm	Session 20:	Cultural Geography I	Kitty Hawk
1:15 – 3:15 pm	Session 21:	Biogeography II	Triad East
1:15 – 3:15 pm	Session 22:	Geomorphology, Rivers, Seas	Cape Fear
1:15 – 3:15 pm	Session 23:	Political Geography I	Triad West
1:15 – 4:15 pm	Session 24:	Poster Display Session III <i>(authors will be at posters from 2:30-4:00pm)</i>	Ballroom Foyer
3:30—5:30pm	Session 25:	GTU Undergraduate Session	Cape Fear
3:30 – 5:30 pm	Session 26:	Active Learning Swapshop II	Blue Ridge
3:30 – 5:30 pm	Session 27:	Geography of School Transportation	Appalachian
3:30 – 5:30 pm	Session 28:	Climate II	Triad Central
3:30 – 5:30 pm	Session 29:	Political Geography II	Triad West
3:30 – 5:30 pm	Session 30:	Urban Social Movement and Urban Spaces	Triad East
3:30 –5:30 pm	Session 31:	Cultural Geography II	Kitty Hawk

World Geography Bowl

5:45 - 7:15 pm WGB Championship Event Triad Ballroom

World Geography Bowl Chair: **Laurence W. Carstensen, Virginia Tech**

Moderator: **Laurence W. Carstensen, Virginia Tech**

Warm-up Round: Student All-Stars vs. Professional Dream Team

Student All-Star Team: **Members from Six Preliminary Round Non-finalist Teams**

Championship Round:

Top two state teams from the SEDAAG Division compete in a single Championship Round, winner takes all. Trophies to the winning team and to the Most Valuable Player.

Honors Banquet

Governors Ballroom

7:30 - 10:00 pm Presiding: **Joby Bass**, Honors Committee Chair
Presentation of Awards
Remarks by **Douglas Richardson**, AAG Executive Director
Honors Address: **John A. Agnew**, President AAG

Day 3

Tuesday

November 25, 2008

Paper Sessions

8:00 - 10:00 am	Session 32: The State of SEDAAG	Blue Ridge
8:00 - 10:00 am	Session 33: Biogeography III	Triad West
8:00 - 10:00 am	Session 34: Urban Rural Dynamics	Triad East
8:00 - 10:00 am	Session 35: Economic/Development Geog II	Appalachian
8:00 - 10:00 am	Session 36: Applications in GIScience III	Triad Central

Business Meeting

10:15 - 12:15 pm Triad Central

Derek H. Alderman, Presiding
President, SEDAAG, East Carolina University

Doug Richardson, Executive Director, AAG

Adjournment *Have a Safe Trip Home!*

PAPER, POSTER AND PANEL SESSIONS

Reminder to Speakers:

If using a digital projector, please bring your file to the room at least ten minutes prior to the beginning of your session. Someone should be there to help you upload your presentation. Remember to keep your presentation to the allotted time (approximately 15 minutes) and promptly obey the chairperson's time cues. Thanks and enjoy a great meeting.

Sunday, November 23, 2008

Session 1 – Plenary Poster Session in Physical Geography*
Sunday 6:00 pm – 8:00 pm – Ballroom Foyer

*** [Authors will be at their posters from 6:00- 7:30.]**

Jesse Brass, East Carolina University, What on Earth Are We Doing Here?: A Descriptive Morphology of the Wrightsville Beach-Masonboro Island Sediment System, North Carolina

Mario Cartaya and Kevin Ash, University of Florida, Sampling Convective Rainfall Rates in Relation to the Distance from the Center of Tropical Storm Fay

Amy Cohen and Shimon Wdowinski, University of Miami, Monitoring the Hydrologic Cycle of the Florida Everglades Using Synthetic Aperture Radar

Jessica Dawkins, University of West Georgia, Using Dendrochronology to Authenticate the Chief John Ross House, Rossville, Georgia

Georgina Deweese, University of West Georgia, Evaluating the Dendrochronological Potential of Central Appalachian Table Mountain Pine (*Pinus pungens* Lamb.) in Climate Reconstructions

Martin B. Farley, P. Lee Phillips, and Rachel McBroom, UNC-Pembroke, Student Investigation of Spatial Changes in Mid-Atlantic Coastal Plain Aquifers

Christopher Fuhrmann, Charles Konrad, Gretchen Carlson, UNC-Chapel Hill, A Climatology of Extreme Weather Across the Southeast United States: Temporal Trends, Relationships with Circulation and Human Impacts

Jacqueline Gallagher and Joe Nicholas, University of Mary Washington, Human Impacts on a Fluvial System: Hazel Run Tributaries, Fredericksburg, VA

Doug Gamble, Matt Ball, UNC-Wilmington and Scott Curtis, East Carolina University, Pentad Scale Variation of the Caribbean Mid-summer Drought and its Association with the North Atlantic High Pressure

Ursula Garfield and Joann Mossa, University of Florida, A Comparison of Stream Power to Channel Change: The Leaf River, Mississippi and Two Tributaries

Linwood Hall and Hong-Bing Su, East Carolina University, An Analysis of Observed Urban Heat Island in Greenville North Carolina and its Implication on Energy Consumption and the Environment

Carly L. Hertz, UNC-Greensboro, Understanding Social Vulnerability of Caribbean Small-Island Developing States

Dustin Kimbrow, University of Alabama, Channel Migration on the Choctawhatchee River, Southeastern Alabama, 1961-2006

Li Li and Guiuan Yan, Old Dominion University, A Comparison of Generalized Linear Regression and Ecological Niche Factor Analysis in Mosquito Breeding Habitat Modeling

Sanjay Lamsal, A. Davis, Monica Dorning, D. Shoemaker, Ross K. Meentemeyer, UNC-Charlotte, Monitoring the Effects of Land Use Change on Soil Carbon and Nitrogen in the Charlotte Metropolitan Area

Alexis McGraw and Adam Watkins, University of Alabama, The Significance of Land Use on Channel Bedform Type

Qingmin Meng and Ross K. Meentemeyer, UNC-Charlotte, Spatial Dispersal Modeling of Sudden Oak Death in Oregon

Leslie A. North, Philip E. van Beynen, University of South Florida, and Mario Parise, National Research Council, Rome, Italy, Applying the Karst Disturbance Index in West-Central Florida and Southeast Italy

Jason S. Polk, University of South Florida, A Multi-proxy Approach to Using Cave Sediment Carbon Isotopes for Late Holocene Paleoenvironmental Reconstruction in Florida

Peter Robinson, Charles Konrad III, Christopher Furhman, Gretchen Carlson, UNC-Chapel Hill, Cooperative Activities at the NOAA Southeast Regional Climate Center

Ahmed Salahuddin and Scott Curtis, East Carolina University, Extreme Rainfall and Madden-Julian Oscillation Over Malaysia

William P. Tyminski, UNC-Greensboro, Tree-ring Data and Estimating Maple Syrup Production in New York

Philip B. White, Appalachian State University and Henri Grissino-Mayer, University of Tennessee, Dendroclimatic Analysis of Oak Species in the Southern Appalachian Mountains

Keith Yearwood, University of Florida, River Planform Change Downstream of the Sinclair Dam, Georgia

Monday, November 24, 2008

**Session 2 - Student Honors Competition I
Monday 8:00 am - 10:00 am –Triad East**

Organizer and Chair: **Joby Bass, University of Southern Mississippi**

Khaula A. Alkaabi, UNC – Greensboro, The Geography of Air Freight by Metropolitan Area

Katie Price, University of Georgia, Impacts of Human Land Use on Surficial Soil Hydraulic Properties in the Southern Blue Ridge

Linda Quiquívix, UNC – Chapel Hill, Nationality “Undefined”: Resistance, Refusal and Place-making Through Placing Subjects in *The Syrian Bride* (2004)

William Terry, University of South Carolina, The Decline of Filipino Seafarer Power: A Legal Space of Worker Disempowerment

Teddy Allen, East Carolina University, Remote Climate Forcing of Jamaica's Mid-Summer Dry Spell and Vegetation Response

**Session 3 - Panel Session: Righting Unrightable Wrongs: Legacies of Racial Violence in the U.S. South
Monday 8:00am-10:00am-Blue Ridge**

Faulkner's quote "The past is not dead. In fact, it's not even past" holds particular relevance for communities which have a legacy of racial violence. For many, the consequences and continued significance of racial violence still represent a major impediment to community development, cross-cultural understanding and racial reconciliation. Perhaps no region in the United States knows more about the legacy of racial violence than the U.S. South. Long associated with lynching, terrorist organizations like White Citizens Councils and the Ku Klux Klan, and the site of unspeakable violence during the modern Civil Rights Movement, today grassroots community organizations and academics are confronting this past in an effort to build community and foster understanding amongst a multiplicity of groups. This panel session brings together a diverse effort to highlight the multiple ways Southern communities are working to overcome the contemporary significance of racial violence.

Organizer: Joshua F.J. Inwood, Auburn University

Chair and Moderator: Joshua F.J. Inwood, Auburn University

Panelists: Cynthia Brown, Greensboro Truth and Reconciliation Commission and The Sojourner Group, Elizabeth Hines, UNC- Wilmington, Joyce Johnson, Beloved Community Center, Jill Williams, Greensboro Truth and Reconciliation Commission and Andrus Family Fund, Karen L. Zipf, East Carolina University

**Session 4 - Special Session in Honor of Stanley D. Brunn, University of Kentucky
Monday 8:00 am - 10:00 am –Triad West**

Organizers: Gerald R. Webster, University of Wyoming, Donald J. Ziegler, Old Dominion University, and Gerald Ingalls, UNC-Charlotte

Chair: Jonathan I. Leib, Old Dominion University

Session Discussant: Thomas Chapman, Georgia Southern University

Donald J. Zeigler, Old Dominion University, Stanley D. Brunn: Intellectual Ancestry and Progeny

Gerald Ingalls and Olga Smirnova, University of North Carolina at Charlotte, Annexation, Incorporation and the Expansion of Central Cities in North and South Carolina

Derek H. Alderman, East Carolina University, Internet Domain Names and the Political Geography of Misdirection: The Case of www.martinlutherking.org.

Kenneth C. Martis, West Virginia University, The Origin and Geographical Spread of the Term Gerrymander in 1812

Gerald R. Webster, University of Wyoming, Flags, Banal Nationalism and the Invasion of Iraq

**Session 5 - New Voices in SEDAAG I: Physical Geography
Monday 8:00 am - 10:00 am –Kitty Hawk**

This is the first of two sessions that spotlight faculty members who have recently joined departments in SEDAAG, providing an opportunity to welcome them to the Regional Division and learn about their research and teaching interests.

Organizer: Derek H. Alderman, East Carolina University

Chair: Scott Leece, East Carolina University

Rosemary Sherriff, University of Kentucky, Climate Change and Spruce Beetle Activity in Forests on the Alaska Peninsula

Discussant: Pete Soule, Appalachian State University

Scott Markwith, Florida Atlantic University, Larry J. Davenport, Samford University, James Shelton, University of Georgia, Kathleen C. Parker, University of Georgia, Michael J. Scanlon, Cornell University, Ichthyochory, Closure of the Suwannee Strait, and Population Divergence in *Hymenocallis Coronaria*

Discussant: Paul Knapp, UNC-Greensboro

John A. Knox, University of Georgia, “Hurricane West Winds”: Observations of High Wind Events Associated with Mid-Latitude Cyclones in the Great Lakes Region

Discussant: Hong-Bing Su, East Carolina University

Rosana Nieto Ferreira and Thomas M. Rickenbach, East Carolina University, Rainfall Organization in the African Sahel: Humble Beginnings of Most Atlantic Ocean Hurricanes

Discussant: Doug Gamble, UNC-Wilmington

**Session 6 - Applications in GIScience I (In Memory of C.P. Lo)
Monday 8:00 am - 10:00 am –Triad Central**

Chair: Charles Roberts, Florida Atlantic University

Aaron W. Binns, Florida State University, Geoinformatic Mapping, Site Prediction, and Cultural Resource Management for the Olmec La Venta Complex of Tabasco, Mexico

Discussant: David Harms Holt, University of Southern Mississippi

Roy Stine, Prasad Pathak and Mary Hall-Brown, UNC - Greensboro, Comparing Image Classification Techniques for Arctic Tundra Land Cover, Toolik, Lake Alaska

Discussant: Luoheng Han, University of Alabama

Tina Delahunty, Texas Tech University and Charles Roberts, Florida Atlantic University, Textural Classification of Historical Urban Landsat Imagery

Discussant: Tim Warner, West Virginia University

Yong Wang, East Carolina University, Mingsheng Liao and Changcheng Wang, Wuhan University, Modification and Extension of an Existing Scattering-model-based Speckle Filter to Coastal Environments

Discussant: Joanne Halls, UNC-Wilmington

Mary Hall-Brown, Roy Stine, Anne Hershey, UNC – Greensboro and Peter Ray, Stanford University, Increasing Multispectral Classification Accuracies by Using Hyperspectral Satellite Imagery in Order to Identify Random and/or Systematic Changes Within the Vegetation of the Upper Kuparuk River Basin, Alaska: 1985-2007

Discussant: Yong Wang, East Carolina University

**Session 7 - Economic and Development Geography I
Monday 8:00 am - 10:00 am –Appalachian**

Chair: James O. Wheeler, University of Georgia

Susan Walcott, UNC - Greensboro, The New U-Turn: Logistics Chain Costs and the North Carolina Furniture Industry

Discussant: Bill Graves, UNC-Charlotte

Christian Sellar, University of Mississippi, The Role of Italian Firms in the “Timisoara Miracle”

Discussant: Mark de Socio, Salisbury University

Dawn M. Drake, University of Tennessee, Is NASCAR Nationalizing out of the South or Is the South Losing Its Uniqueness: A Spatial Analysis 1992 to 2007

Discussant: Ron Mitchelson, East Carolina University

Ronald Kalafsky, University of Tennessee, Maintaining Domestic Production Through Exports: The Case of Japan’s Metal Forming Machinery Sector

Discussant: Christian Sellar, University of Mississippi

James O. Wheeler, University of Georgia, America's New Manufacturing Centers in the Global Economy: Exports by Value, 2006

Discussant: Ron Kalafsky, University of Tennessee

**Session 8 – Hurricane Prediction and Impacts
Monday 8:00 am - 10:00 am –Cape Fear**

Chair: Graham A. Tobin, University of South Florida

Scheitlin, Kelsey, Florida State University, Increasing Losses from Hurricanes Affecting Florida

Discussant: Clifton Dixon, University of Southern Mississippi

Jill Malmstadt, Florida State University, Minimum Pressure as Predictor for Hurricane Losses in Florida

Discussant: Heidi Lannon, Santa Fe Community College

Heather Ward, East Carolina University, Hurricanes and Global Warming: Editorial Discourse Before and After Katrina

Discussant: Jennifer Collins, University of South Florida

Graham A. Tobin and Jeff Burton, University of South Florida, Spatial and Temporal Patterns of Wind Damage to Residential Structures from Hurricane Charley: The Role of Building Codes and Age of Structures

Discussant: Jerry Mitchell, University of South Carolina

**Session 9 – Poster Session II*
Monday 9:00 am – 12:00 pm – Ballroom Foyer**

*** [Authors will be at their posters from 9:30- 11:00.]**

Kamal Alsharif, University of South Florida, Comparing the Technical and Financial Water Resources Management Indicators in the West Bank and the Gaza Strip

Rebecca K.R. Ambers, Sweet Briar College, Comparison of a Civil War Map of Amherst and Nelson Counties, Virginia with U.. Census Records Using GIS

Shrinidhi Ambinakudige, Mississippi State University, Revisiting “the South” and “Dixie”: A Spatial Pattern Analysis of Vernacular Regions Using GIS

Raymond Atkinson, UNC-Greensboro, The Impact of the North Carolina Research Campus on Kannapolis

Andrew Bennett, East Carolina University, The Rise and Fall of Ocean Pearl Highway

Susan J. Bergeron, West Virginia University, Engaging the Virtual Landscape: the Spatial Experience Engine and Historical Landscape Reconstruction

Ronald Bertucci and Joby Bass, University of Southern Mississippi, Sweet Tea: Mapping a Foodway in the U.S.

Gillian Breary and Charles E. Roberts, Florida Atlantic University, Mapping Urban Growth in Boca Raton Over a Thirty Year Period

David M. Brommer and Jason C. Senkbeil, University of Alabama, An Analysis of Meteorological Variables Impacting Evacuation Decisions During Hurricane Gustav

Amy J.S. Davis and Ross K. Meentemeyer, UNC-Charlotte, The Influence of Urbanization and Land Use Change on Exotic Plant Invasions

Eric Delmelle, UNC-Charlotte, Optimizing Bus Stop Locations in a GIS Environment

Maria Fadiman, Florida Atlantic University, Protect the Rainforest by Using It

Christopher Fuhrmann, Gretchen S. Carlson, Charles E. Konrad, Peter J. Robinson, UNC-Chapel Hill, Jet Scream or Jet Plane? The Effects of Climate on Influenza in the United States

Sophia Giebultowicz, Elixzbeth Root and Michael Emch, UNC-Chapel Hill, Indirect Protection due to Social Networks and Space in a Cholera Vaccine Trial

Samuel Trey Gill and David Harms Holt, University of Southern Mississippi, Initiating Campus Recycling Efforts Post Katrina: How a Student Organization Took the Lead in Developing a Recycling Initiative at the University of Southern Mississippi

Jerry Griffith, University of Southern Mississippi, William Hargrove, US Forest Service, Forrest Hoffman, Oak Ridge National Laboratory, Phenological Regions of the Conterminous United States

Bandana Kar, University of Southern Mississippi and Michael E. Hodgson, University of South Carolina, Is DEM a Better Substitute for Floor Elevation of Residential Structures?

Erika Milani and Charles Roberts, Florida Atlantic University, Mapping Greenspace-Impervious Area at the Lot Level Using Digital Image Analysis Procedures

Stephen Garrett Nelson, East Carolina University, 4Chan.org: Mapping a Subversive Virtual Place

Anna Pounders and John C. Rodgers III, Mississippi State University, The Mexican Migrant Population of Northeast Mississippi

Jason C. Senkbeil, University of Alabama, The Cry Wolf Index: Perceived Landfall Distance vs. Actual Landfall Distance for Gustav Evacuees

Cindy Shaw and Charles Roberts, Florida Atlantic University, Mapping Automobile Space through Digital Image Analysis of DOQQS of Pompano Beach, Florida

Wei Tu and Kirk McElveen, Georgia Southern University, Mapping and Detecting Spatial Clusters of Low Birth Weight Incidences in Southeast Georgia

James L. Wilson, Christopher J. Mansfield and Denise A. Kirk, East Carolina University, Spatially Interpolating Rates: A Public Health Application

Session 10 - Student Honors Competition II
Monday 10:15 am - 12:15 pm –Triad East

Organizer: Joby Bass, University of Southern Mississippi
Chair: Ross K. Meentemeyer, UNC-Charlotte

James Baginski, University of Tennessee, Southern Suds Tapping Out?: An Analysis of Craft Brewing in the Southern United States

Brian Blickenstaff, University of Southern Mississippi, Comuna 13, as Dangerous as They Say? Comparing Perceptions with Crime Data in Medellin, Colombia

Justin Maxwell, Appalachian State University, Drought and Other Driving Forces Behind Population Change in Rural Counties in the United States

Katherine A. Renken, East Carolina University, Alongshore Variation in Beach and Dune Changes at Microtidal Inlets Along the Outer Banks of North Carolina

Ginette Wessel, UNC – Charlotte, Spatial Information in the Environment: Investigations of GPS and Road Map Navigation

Session 11 - Panel Session: Local Government Boundary Change in North Carolina
Monday 10:15 am - 12:15 pm –Blue Ridge

Between 1990 and 2008 forth-six (46) new municipalities were established in North Carolina. Additionally, recent large involuntary or unilateral annexations by the City of Greensboro, the City of Winston-Salem and other municipalities throughout the State has

resulted in a major lobbying effort in Raleigh to change the existing 50 year old annexation statutes. The study of these new cities and annexation activities falls under the purview of the larger field of boundary change. Boundary change can take the form of annexations, consolidations/mergers, secessions, the formation of special districts, and incorporations. This panel session is dedicated to discussing local government boundary change in the State of North Carolina by engaging local government practitioners academics, and other interested parties in conversation. Local government officials from the Piedmont Triad region of North Carolina will provide their insight into the changing urban and political geography of the Greensboro/Winston-Salem/High Point Combined Statistical Area. Additionally, the panel will discuss recent patterns of municipal incorporation and annexation activity throughout North Carolina.

Organizer: Russell M. Smith, Winston-Salem University

Chair and Moderator: Russell M. Smith, Winston-Salem University

Panelists: Gerald Ingalls, UNC-Charlotte, Bruce Oakley, Town of Oak Ridge, NC, Michael Brandt, Town of Summerfield, NC, Tammy Kepley, City of Lexington, NC

**Session 12 - Presidential Session on Southern Studies in Geography
Monday 10:15 am - 12:15 pm –Triad West**

Through the SEDAAG Southern Studies Committee and the *Southeastern Geographer*, the Regional Division has a long and distinguished history of examining the American South and its many economic, political, cultural, and environmental issues. The recent establishment of an AAG specialty group devoted to the study of the American South is indicative of the growing national importance of southern studies within geography. This presidential session highlights critical work on southern studies, bringing together established scholars and emerging voices to present and comment on research.

Sponsors: Southern Studies Committee, SEDAAG

Study of the American South Specialty Group, AAG

The Southeastern Geographer

Organizers: Derek H. Alderman, East Carolina University and Tyrel G. Moore, UNC-Charlotte

Chair: Tyrel G. Moore, UNC-Charlotte

Jonathan Leib, Old Dominion University and Gerald Webster, University of Wyoming, “What Would Robert E. Lee Do?”: Race, Religion and the Confederate Battle Flag

Discussant: Tyrel G. Moore, UNC-Charlotte

Joshua Inwood, Auburn University, After the Love Has Gone: The Politics of Love and Dr. King’s Relevance for 21st Century Community Development

Discussant: Derek H. Alderman, East Carolina University

Jamie Winders, Syracuse University, What if the South Doesn't Matter? Immigration, Scale, and the Politics of Change

Discussant: Heather Smith, UNC-Charlotte

Katie Algeo, Western Kentucky University, Tourism's Tragedy of the Commons at Mammoth Cave

Discussant: Michael Steinberg, University of Alabama

E. Arnold Modlin, Jr., Louisiana State University, and Derek H. Alderman, East Carolina University, (In)Visibility of the Enslaved within Online Plantation Tourism Marketing: A Textual Analysis of North Carolina Websites

Discussant: Elizabeth Hines, UNC-Wilmington

**Session 13 - New Voices in SEDAAG II: Human Geography
Monday 10:15 am - 12:15 pm –Kitty Hawk**

This is the second of two sessions that spotlight faculty members who have recently joined departments in SEDAAG, providing an opportunity to welcome them to the Regional Division and learn about their research and teaching interests and experiences.

Organizer: Derek H. Alderman, East Carolina University

Chair: Jeff Popke, East Carolina University

Joshua Barkan, University of Georgia, The Role of Law in the Rescaling of Statehood: Some Insights Concerning Economic Regulation

Discussant: Donald Zeigler, Old Dominion University

Corey Johnson, UNC-Greensboro, The “Mezzogiorno Trope”: Peculiar Nationalism and the Politics of Spatial Representation in Germany

Discussant: William Porter, Elizabeth City State University

Nina Martin, UNC-Chapel Hill, Precarious Jobs, Vulnerable Workers, and Migrant Civil Society in Chicago

Discussant: Johnathan Walker, James Madison University

Micheline van Riemsdijk, University of Tennessee, New Public Management in Elder Care in Norway: Implementation and Outcomes

Discussant: Eric Fournier, Samford University

Jennifer Speights-Binet, Samford University, and Jeff Lash, University of Houston, Clear Lake, Growing Geographers in Texas Soil: An Ethnographic Study of Teaching and Learning Geography in the Field

Discussant: Elizabeth Leppman – Writer, Map /Book Editor – Lexington, KY

**Session 14 – Applications in GIScience II (In Memory of C.P. Lo)
Monday 10:15 am - 12:15 pm –Triad Central**

Chair: Timothy Warner, West Virginia University

Lisa Jordan, Florida State University, Humanitarian Geographic Information Systems
Discussant: Matthew Zook, University of Kentucky

Matthew Brunt, Western Kentucky University, Before the Park: Creating a HGIS of Mammoth Cave Area Communities Circa 1920
Discussant: Tina Delahunty, Texas Tech University

Yuhong Zhou, UNC – Charlotte, A Conceptual Framework for Analyzing and Understanding Pedestrian Movement Behaviors by Using Continuous Geospatial Lifeline Based on GPS Data
Discussant: Diansheng Guo, University of South Carolina

Luoheng Han, University of Alabama, Estimating Water Quality Parameters in a Reservoir Using Spectral Reflectance
Discussant: Yong Wang, East Carolina University

Timothy Warner, West Virginia University and Jong Yeol Lee, Korea Research Institute for Human Settlements, Adaptive, Context-dependent Multi-scale Image Texture
Discussant: Steve Walsh, UNC-Chapel Hill

Session 15 - Biogeography I
Monday 10:15 am - 12:15 pm –Cape Fear

Chair: John Kupfer, University of South Carolina

Paul A. Knapp, University of North Carolina, Greensboro, Can Rising Atmospheric CO₂ Conditions Influence Dendroclimatic Reconstructions?
Discussant: Georgina Deweese, University of West Georgia

Garrett Graddy, University of Kentucky, Seed Ag: Situating *in situ*
Discussant: Kelly Gregg, Jacksonville State University

Jaclyn Hall, University of Florida, Does Forest Cover Mean a Forest? Floristic Comparison of Protected and Cardamom Agro-Forests
Discussant: William Tyminski, UNC-Greensboro

D. J. Keellings, University of Florida, C.M. Knickerbocker, S. Leitholf, E.L. Stephens, H. Laird, C.J.R. Anderson, J. E. Fauth, and P.F. Quintana-Ascencio, University of Central Florida, Tree Encroachment of A Sawgrass (*Cladium jamaicense*) Marsh within an Increasingly Urbanized Ecosystem
Discussant: Scott Markwith, Florida Atlantic University

John Kupfer, University of South Carolina, Assessment Watershed Integrity with a Flexible Indicator-Based Approach

Discussant: Tomas Vaclavik, UNC- Charlotte

**Session 16 - Social and Cultural Networks, Flows and Spaces
Monday 10:15 am - 12:15 pm –Appalachian**

Chair: Ann M. Oberhauser, West Virginia University

Adam Keul, Florida State University, Non-place or Place of Transit-the Mobile World of a Hurricane Evacuation Shelter

Discussant: Graham A. Tobin, University of South Florida

Thomas L. Bell and Margaret M. Gripshover, University of Tennessee, Can I Get a Witness? Making the Case for Gatlinburg Ambience

Discussant: Michael Crutcher, University of Kentucky

Christina Griffin, University of South Carolina, Gender and Social Capital: Dependent Factors in Rebuilding Networks Post Disaster

Discussant: Helen Ruth Aspaas, Virginia Commonwealth University

Sara Beth Keough, Saginaw Valley State University, Leaving Home for Home: Migration of Newfoundlanders to Alberta, Canada

Discussant: Jamie Strickland, UNC-Charlotte

Ann M. Oberhauser, Amy Gentzler and David Westerman, West Virginia University, R u OK? Mis u lots:~) Use of Information and Communication Technologies in Social Relationships

Discussant: Hilda Kurtz, University of Georgia

**Session 17 – Panel Session: Active Learning Swap Shop I
Monday 1:15 pm - 3:15 pm –Blue Ridge**

SEDAAG members are invited to a session on active learning. Many professors recognize the importance of including some active learning techniques to present material to their class. This session will be an active learning swap-shop where you will learn some innovative and creative ideas to increase student participation in the classroom.

Organizers: Jennifer Collins, University of South Florida

Chair and Moderator: Jennifer Collins, University of South Florida

Sponsors: SEDAAG Education Committee, AAG EDGE Project

Panelists: Lisa Jordan, Florida State University, Peggy Gripshover, University of Tennessee, Jennifer Rahn, Samford University

**Session 18 - Newcomers, New Energy, New Jobs, and the NASCAR in North Carolina
Monday 1:15 pm - 3:15 pm –Appalachian**

Sponsor: Study of the American South Specialty Group, AAG and the North Carolina Geographical Society

Session explores economic development within North Carolina, focusing on the issues facing the state's new economic geographies.

Organizers: William Graves, UNC-Charlotte and Derek H. Alderman, East Carolina University

Chair: Ron Kalafsky, University of Tennessee

Session Discussant: Susan Walcott, UNC-Greensboro

Thomas W. Crawford and Don E. Bradley, East Carolina University, How Do Retirement, Migration, and Tourism Impact Residential Development in Coastal North Carolina?

Keith G. Debbage and Jacob Kidd, UNC-Greensboro, Renewable Energy in North Carolina: The Potential Supply Chain

Ron Mitchelson and Derek H. Alderman, East Carolina University, The NASCAR Cluster in Charlotte: It's No Accident

Tyrel G. Moore and Jamie L. Strickland, UNC-Charlotte, Economic Restructuring, Industrial Job Losses and Community Redevelopment Challenges: The View from Cabarrus County, North Carolina

William Graves and Jonathan Kozar, UNC - Charlotte, Gigs and Geeks: The Payoff of North Carolina's Post-Industrial Economic Development Policy

**Session 19 - Climate I
Monday 1:15 pm - 3:15 pm –Triad Central**

Chair: Peter R. Waylen, University of Florida

Erin L. Bunting, University of Florida, The Spatial Distribution of Tropical Cyclone Rainfall in Relation to the Radius of Gale-Force Winds in U.S. Landfalling Storms

Discussant: John Rogers, Mississippi State University

Scott Curtis, East Carolina University, ENSO'S Global Influence on the Seasonal Distribution of Daily Rainfall

Discussant: Corene Matyas, University of Florida

Andrew Grundstein and Vernon Meentemeyer, University of Georgia, Maximum Vehicle Cabin Temperatures Under Different Meteorological Conditions

Discussant: Charles Konrad, UNC-Chapel Hill

Peter Waylen and Kwadwo Owusu, University of Florida, Intra-annual and Inter-decadal Changes in Combinations of the Agro-climatological Variables Rainfall Totals and Numbers of Rainy Days at Berekum, Ghana
Discussant: Scott Curtis, East Carolina University

Session 20 - Cultural Geography I
Monday 1:15 pm - 3:15 pm –Kitty Hawk

Chair: Stephen Birdsall, UNC-Chapel Hill

John A. Benitez, University of Kentucky, The U.S. South as A New Missionary Frontier? Institutional Protestantism, Strategies, and Hispanic Outreach Ministry
Discussant: Robert Kruse, West Liberty State College

Kathryn Ziewitz, Florida State University, From Redneck Riviera to Florida's Great Northwest: The Rebranding of Florida's Panhandle
Discussant: Katie Algeo, Western Kentucky University

Ira M. Sheskin, University of Miami, Jews in the South: An Update
Discussant: Thomas Bell, University of Tennessee

Deborah J. Thompson, University of Kentucky, Region, Race, Representation: Traditional African American Music in Appalachia
Discussant: Maria Fadiman, Florida Atlantic University

Stephen Birdsall, UNC – Chapel Hill, Living Personal Memorials
Discussant: Daniel McGowin, Florida State University

Session 21 - Biogeography II
Monday 1:15 pm - 3:15 pm –Triad East

Chair: Peter T. Soule, Appalachian State University

Joni Downs, University of South Florida, Application of Time Geography to the Analysis of Animal Locational Data
Discussant: Elizabeth M. Walton, UNC – Greensboro

John R. Grimes, Eastern Kentucky University, Rediscovering the Cacao of Ecuador's Upper Napo River Valley
Discussant: Mary Finley-Brook, University of Richmond

Alicia M. Ellis, Tomas Vaclavik, and Ross K. Meentemeyer, UNC- Charlotte, Accounting for Effective Connectivity in Spatially Explicit Disease Models.
Discussant: Li Li, Old Dominion University

Elizabeth M. Walton, UNC – Greensboro, Using Ecological Niche Modeling to Predict Actual and Potential Habitat for the Bog Turtle *Glyptemys muhlenbergii*

Discussant: Joni Downs, University of South Florida

Peter T. Soule, Appalachian State University, Changing Climate and Radial Tree Growth in a High Elevation Spruce-Fir Ecosystem on Grandfather Mountain, North Carolina

Discussant: Rosemary Sherriff, University of Kentucky

**Session 22 – Geomorphology, Rivers, Seas and Streams
Monday 1:15 pm - 3:15 pm –Cape Fear**

Chair: Joann Mossa, University of Florida

Jordan A. Clayton, Georgia State University, Geomorphic Adjustment, Geographic Context, and Disturbances

Discussant: Carol Harden, University of Tennessee

Nathan Kettle, University of South Carolina, Sea Level Rise in the Carolinas: A Review of Rates, Methodologies, and Impacts

Discussant: Michael Mayfield, Appalachian State University

Jorene Hamilton, University of Tennessee, and Ingrid Luffman, East Tennessee State University, Precipitation, Pathogens, and Sediment Trends in the Little River, Tennessee

Discussant: Jacqueline Gallagher, University of Mary Washington

Richard Cartwright, Georgia State University, Analysis of an Apparent Dendritic Basin on the Surface of Titan

Discussant: Robert Brinkmann, University of South Florida

Joann Mossa, Jim Rasmussen and Ursula Garfield, University of Florida, Bed Sediments in Runs Undergoing Restoration: Kissimmee River, Florida

Discussant: L. Allan James, University of South Carolina

**Session 23 - Political Geography 1
Monday 1:15 pm - 3:15 pm –Triad West**

Chair: Gerald Webster, University of Wyoming

Stanley D. Brunn, University of Kentucky, Gender, Race and Ethnicity on U.S. Postage Stamps: A Visual Reading of American History

Discussant: Jonathan Leib, Old Dominion University

Henry Way, James Madison University, The Geographical Techniques of Campaign Politics: A Case Study from the Heartland

Discussant: Kenneth Martis, West Virginia University

Nicholas Quinton, Florida State University, and Gerald Webster, University of Wyoming, Voting in Alabama, Put in its “Place”

Discussant: Gerald Ingalls, UNC-Charlotte

John W. McEwen, Florida State University, An Examination of Election Results Anomalies in the Bible Belt in Florida

Discussant: Henry Way, James Madison University

Ariel Goldring and Jennifer Williams, Temple University, Three Propositions for the Propagation of Alternative Energy in Jamaica

Discussant: Tony Abbott, Stetson University

Session 24 – Poster Session III*

Monday 1:15 pm – 4:15 pm – Ballroom Foyer

*** [Authors will be at their posters from 2:30- 4:00.]**

Philip L. Chaney and Greg S. Weaver, Auburn University, Public Response to Warnings During the Super Tuesday Tornado Disaster at Lafayette, Tennessee

Laura Coppola, UNC-Charlotte, The Jewish Experience in the American South

Mike Crane, University of South Florida, Impact of Urban Redevelopment Policies on Slum Growth Growth in Ahmedabad, India

Monica Dorning, D. Shoemaker and Ross K. Meentemeyer, UNC-Charlotte, Forecasting Development in the Greater Uwharries: Outcomes of Status Quo and Conversation-Based Planning Scenarios

V. Escamilla, M. Emch, C. Feldacker, M. Yunus, V.D. Thiem, and M. Ali, UNC-Chapel Hill, Local Environmental Drivers of Cholera in Bangladesh and Vietnam

Jake Gentry and Christopher A. Badurek, Appalachian State University, A Multi-method Geographic Analysis of Refugee Camp Impacts on Host Communities in Western Tanzania

Rachel Godwin, UNC-Charlotte, Weathering the Tropical Cyclone: Improving Public Assistance via Vulnerability Assessment for the Older Population of New Hanover County, NC

L.A. Hunter and C. A. Badurek, Appalachian State University, Integrating GIS and Geosensors to Support Sustainable Agriculture in a North Carolina Mountain Vineyard

Timothy Mulrooney, Winston-Salem State University, The Movement of Part I Crimes in Winston-Salem, North Carolina, 2002-2005

Stephen O'Connell, University of Mary Washington, Visiting the Sea of Sapphire: A History of Access and Amenity on the Road to Crater Lake

Naomy Perez-Sanchez, East Carolina University, Seasonal Variability in Beach Profile at a Caribbean Location: Puerto Rico*

Robyn Polinsky, Georgia State University, Utilizing Green Roofs as Tools for Storm Water Management in an Urban Metropolis

L. Jesse Rouse, West Virginia University, Finding Meaning in Cultural Landscapes Through Viewshed Analyses

Rosemary M. Rowe, University of Southern Mississippi, Submerging History: Mapping Archaeological Sites Affected by the Three Gorges Dam Reservoir

Sam Schramski, University of Florida, Soot Sayers: Charcoal Production in Calakmul and the Portent for Land Use Change

Will Spence, Georgia Southern University, Using GIS to Predict at Risk Areas of the Southern Pine Beetle in Georgia

Leanne Sulewski, UNC-Greensboro, The Disappearing Act: Quantifying Thermokarst Change in the Campsite Lake Watershed*

Amanda J. Todd, UNC-Greensboro, Spirituality, Mythology and Landscape Perceptions in the 21st Century: Power Mountains and Healing Waters of North Carolina

Alicia Williams and Jennifer Collins, University of South Florida, Geographical Implements of the Florida Interstate-4 Disaster

Wilson, Laura, Neighborhood Place-Framing, Gentrification and the Local State

**Session 25 – Gamma Theta Upsilon Undergraduate Honors
Monday 3:30 pm - 5:30 pm –Cape Fear**

Chair: Tony Abbott, Stetson University

Wendy J. Griffioen, University of Southern Mississippi, Potential Costs of Implementing the Proposed Municipal Zoning Changes Post-Hurricane Katrina: A Case Study in Long Beach, Mississippi

Keith Garrett, University of Mary Washington, GIS in Disaster Management

David Hansen, University of Southern Mississippi, Exploring Patterns of Repopulation and Rebuilding of Gulfport, Mississippi Following Hurricane Katrina, a GIS Based Approach

Kiryssa Kasprzyk, Stetson University, Ethical Implications of Carbon Offsets in the World-System

Sam Rabin, Stetson University, Institutional Barriers to Implementation of a GHG Audit in University Settings

**Session 26 – Panel Session: Active Learning Swap Shop II
Monday 3:30 pm – 5:30 pm –Blue Ridge**

SEDAAG members are invited to a session on active learning through field based experiences. Most geographers recognize the benefits of getting students outside the classroom. This workshop will show you how to make that experience the most effective learning opportunity.

NOTE: Pre-registration with the Session Chair is required to participate in this session.

Organizer and Chair: Eric Fournier, Samford University

Workshop Leaders: Doug Gamble, UNC-Wilmington and Jennifer Speights-Binet, Samford University

Sponsors: SEDAAG Education Committee, AAG EDGE Project

**Session 27 - Geographies of School Transportation in 21st Century America
Monday 3:30 pm - 5:30 pm –Appalachian**

Organizer and Chair: Selima Sultana, UNC-Greensboro

Session Discussant: Richard Crepeau, Appalachian State University

Noreen C. McDonald, UNC – Chapel Hill, Why Parents Take Kids to School? Evidence from the San Francisco Bay Area

Matt Talbott, UNC – Greensboro, Demographic Characteristics of Pedestrian and Bicycle Accidents: Which Groups of Children Should be Targeted for Safe Routes to School Program?

William Powell, UNC – Greensboro, Home to School Transportation Cost for K-6 Children in Ashe County, NC: A Spatial Equity Issue in Rural Counties

Amanda Espy-Brown and Linda S. Watson, University of Alabama, Impacts of the

Social and Built Environments on Active Transport Patterns to a Neighborhood School in Alabama

Selima Sultana, UNC – Greensboro, To and From Schools: Do Travel Distance and Time Affect Whether or Not Children Ride the School Bus?

Session 28 - Climate II
Monday 3:30 pm - 5:30 pm –Triad Central

Chair: Jennifer Arrigo, East Carolina University

Ryan Covington, East Carolina University, Tourist Climate Perceptions: Developing a Climate-Tourism Index for North Carolina's Outer Banks

Discussant: Jonathan Herbert, Jacksonville State University

Corene Matyas, University of Florida, Comparing the Wind and Rain Fields of Tropical Cyclones at Landfall

Discussant: Rosana Nieto Ferreira, East Carolina University

Christy Swann and Paul A. Gares, East Carolina University, Frequency/Magnitude of Wind Events in Eastern North Carolina

Discussant: Erin Bunting, University of Florida

Jonathan Herbert, Jacksonville State University, Historic Climate Change in the Southeastern National Parks

Discussant: Vernon Meentemeyer, University of Georgia

Jennifer Arrigo, East Carolina University, Observed and Modeled Effects of Land Atmosphere Coupling on Soil Moisture over an Agricultural Region

Discussant: Peter Waylen, University of Florida

Session 29 – Political Geography II
Monday 3:30 pm - 5:30 pm –Triad West

Chair: Stanley D. Brunn, University of Kentucky

Nicholas Campiz, University of Florida, The Jurisdictional Arrangement of Sub-National Island Territories: Newfoundland and Labrador

Discussant: Corey Johnson, UNC-Greensboro

Matthew L. Mitchelson, University of Georgia, The Political Implications of Counting Prisoners in the USA

Discussant: Gerald Webster, University of Wyoming

Michelle Brym, University of Tennessee, The Presence of the Polish-German Border in the Lives of Polish University Students

Discussant: Julie Mura, Florida State University

Ryan James, UNC - Charlotte, Modeling States Legislative Response to *Kelo v New London*

Discussant: Joshua Barkan, University of Georgia

Mary Finley-Brook, University of Richmond, Can 'Climate Justice' Be Achieved in Central American Clean Development?

Discussant: Klaus Meyer-Arendt, University of West Florida

**Session30 - Urban Social Movements and Urban Spaces
Monday 3:30 pm - 5:30 pm –Triad East**

Chair: Katherine B. Hankins, Georgia State University

Seth Gustafson, University of Georgia, Social Movement Framings and Globalizing City: Preliminary Findings from a Relational Case Study of 1990-1996 Atlanta

Discussant: Ira Sheskin, University of Miami

Kelly Bennett, UNC-Greensboro, Revisiting the Performance of Magnet Schools to Recentralize American Middle Class Families in the Midst of High Gas Prices: Can Magnet Programs Offer High-Performing Neighborhood Schools in Gentrifying Neighborhoods

Discussant: Katherine B. Hankins, Georgia State University

Xuchu Meng and Wei-Ning Xiang, UNC-Charlotte, Incorporating Linear Landscape Diversity into Greenway Alignment Planning

Discussant: Russell Smith, Winston-Salem State University

Katherine B. Hankins, Georgia State University, Philanthropy's Era(s) and the Making of Urban Spaces

Discussant: Owen J. Furuseth, UNC-Charlotte

**Session 31 – Cultural Geography II
Monday 3:30 pm - 5:30 pm –Kitty Hawk**

Chair: Robert Yarbrough, Georgia Southern University

James Looney, University of Kentucky, Listening about Houses: Architectural Stories on Ocracoke Island, North Carolina

Discussant: Joseph Palis, UNC – Chapel Hill

Daniel McGowin, Florida State University, Public Memory and Identity at Chiang Kai-shek Memorial Hall in Taipei, Taiwan

Discussant: Stephen Birdsall, UNC-Chapel Hill

Joseph Palis and Matthew Reilly, UNC – Chapel Hill, The Ties That Bind: Early Cinematic Representations of American Empire from the Philippines to Cuba 1899

Discussant: James Looney, University of Kentucky

Robert Kruse, West Liberty State College, Barack Obama and the Geographies of Whiteness

Discussant: Joshua Inwood, Auburn University

Robert A. Yarbrough, Georgia Southern University, Beyond Atlanta: Contemporary Latin American Immigrant Settlement In North and South Georgia

Discussant: Sara Beth Keough, Saginaw Valley State University

Tuesday, November 25, 2008

Session 32 - Panel Session: The State of SEDAAG: A Forum on the Future of the Regional Division

Tuesday 8:00 am - 10:00 am –Blue Ridge

The forum provides an opportunity to have a critical dialogue about the present direction of the Regional Division, its new and continuing strengths, its weaknesses and areas in need of improvement, and its changing look and status within the institutional culture of geography. The session seeks to explore the challenges and opportunities currently facing SEAAG and get feedback from members about how best to negotiate the role of tradition and transition in the organization. In other words, what about the Division should be changed and what should be left the same?

Organizer: Derek H. Alderman, East Carolina University

Chair and Moderator: Derek H. Alderman, East Carolina University

Panelists: Katie Algeo, Western Kentucky University, Bob Brinkmann, University of South Florida, Russ Ivy, Florida Atlantic University, Allan James, University of South Carolina, Ron Mitchelson, East Carolina University, Tyrel G. Moore, UNC-Charlotte, Gerald Webster, University of Wyoming.

Session 33 - Biogeography III

Tuesday 8:00 am - 10:00 am –Triad West

Chair: Justin Hart, University of North Alabama

Ross K. Meentemeyer, UNC – Charlotte, Nik Cunniffe, Cambridge University, Richard Hunter, UNC-Charlotte, David Rizzo, UC-Davis, Alex Cook and Christopher Gilligan, Cambridge University, Spread of Sudden Oak Death: Application of Stochastic Epidemic Modeling to Realistic Landscapes
Discussant: Jerry Griffith, University of Southern Mississippi

Bradley Bereitschaft and Timothy Mulrooney, UNC – Greensboro, A Comparative Assessment of Organic Agriculture in the American Southeast
Discussant: John R. Grimes, Eastern Kentucky University

Tracy Van Holt, University of Florida, Adaptive Capacity for Fisher Success
Discussant: Gabrielle Katz, Appalachian State University

Justin Hart, University of North Alabama, Saskia L. van de Gevel, Appalachian State University, and Henri D. Grissino-Mayer, University of Tennessee, A Century of Reserve Management and Change in a Ridge and Valley Forest
Discussant: Jaclyn Hall, University of Florida

Session 34 - Urban-Rural Dynamics
Tuesday 8:00 am - 10:00 am –Triad East

Organizer and Chair: Christopher Badurek, Appalachian State University

L. Joe Morgan and Mayur A. Gosai, UNC – Greensboro, Rural-Urban Migration in Developing or Less Developed Countries: The case of Bhutan
Discussant: Kathleen Schroeder, Appalachian State University

Joseph Sloop, UNC-Greensboro and Christopher Badurek, Appalachian State University, Spatiotemporal Character of Rural Journey to Crime in Yadkinville, NC
Discussant: Laurie Garo, UNC-Charlotte

J. Greg Dobson, UNC – Asheville, Neil Thomas, Resource Data, Inc., and Paul Dezendorf, UNC – Asheville, Development of a Parcel-based Density Analysis Tool to Evaluate Growth Patterns in Western North Carolina
Discussant: Kendrick Curtis, University of Tennessee

Christopher Badurek and Austin Chamberlain, Appalachian State University, Use of Land Parcel Data for GIS Analysis of Rural Gentrification in Watauga County, NC
Discussant: Neil Thomas, Resource Data, Inc.

Kendrick J. Curtis, University of Tennessee, Beyond the Pipe in Rutherford County, Tennessee
Discussant: Christopher Badurek, Appalachian State University

Session 35 - Economic and Development Geography II
Tuesday 8:00 am - 10:00 am –Appalachian

Chair: Edward R. Carr, University of South Carolina

Abigail Foulds, University of Kentucky, “We help: we create jobs!” Entrepreneurial Expatriates and Tourism in Granada, Nicaragua

Discussant: Nina Martin, UNC-Chapel Hill

Thomas F. Howard, Armstrong Atlantic State University, Monitoring Pakistan’s Gwadar Port Project

Discussant: James Wheeler, University of Georgia

Benjamin Shultz and Charlynn Burd, University of Tennessee, Knoxville, The Southern Gentry: Re-Examining Patterns of Growth and Change in the New South

Discussant: Edward R. Carr, University of South Carolina

Kelly D. Gregg, Jacksonville State University, Establishing a Date for the Construction of a Mid-19th Century Cotton Gin-Carder

Discussant: Thomas F. Howard, Armstrong Atlantic State University

Edward R. Carr, University of South Carolina and Brent McCusker, West Virginia University, Development and the Emerging Food Crisis in Mulanje District, Malawi

Discussant: Richard Sambrook, Eastern Kentucky University

Session 36 – Applications in GIScience III (In Memory of C.P. Lo)

Tuesday 8:00 am - 10:00 am –Triad Central

Chair: David Harms Holt, University of Southern Mississippi

Session Discussant: Charles Roberts, Florida Atlantic University

Joanne N. Halls, UNC - Wilmington, A Spatio-Temporal Investigation of Barrier Island Marsh Distribution and Topography at Topsail Island, North Carolina

Matthew Zook, University of Kentucky, Exploring the GeoWeb: An Analysis of the Extent of User Generated Spatial Data on the Internet

David Harms Holt, University of Southern Mississippi, Understanding Turkey Creek: Trying to Help Save a Heritage Site with Aerial Photographs, Mapping, and Ground Truthing

David L. Shaeffer, East Carolina University, Protecting Wetlands Using High Resolution Remote Sensing and GIS

FIRST FLOOR

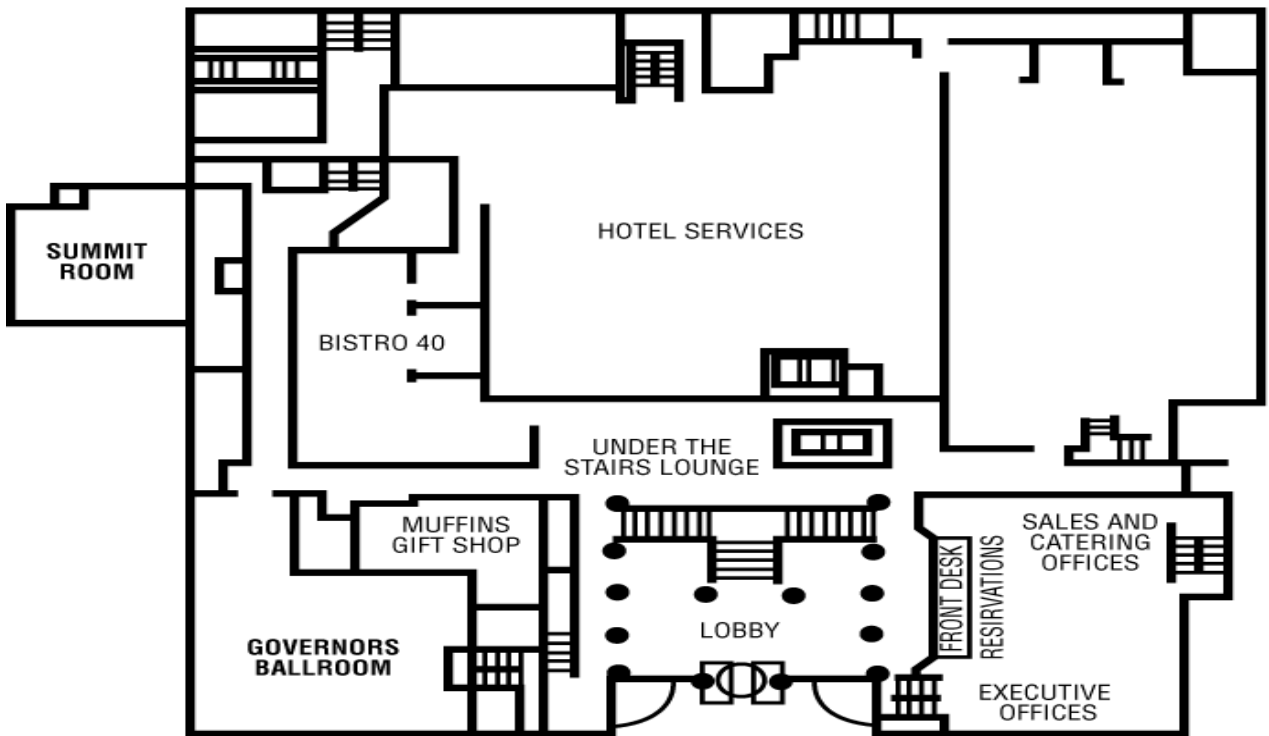

SECOND FLOOR

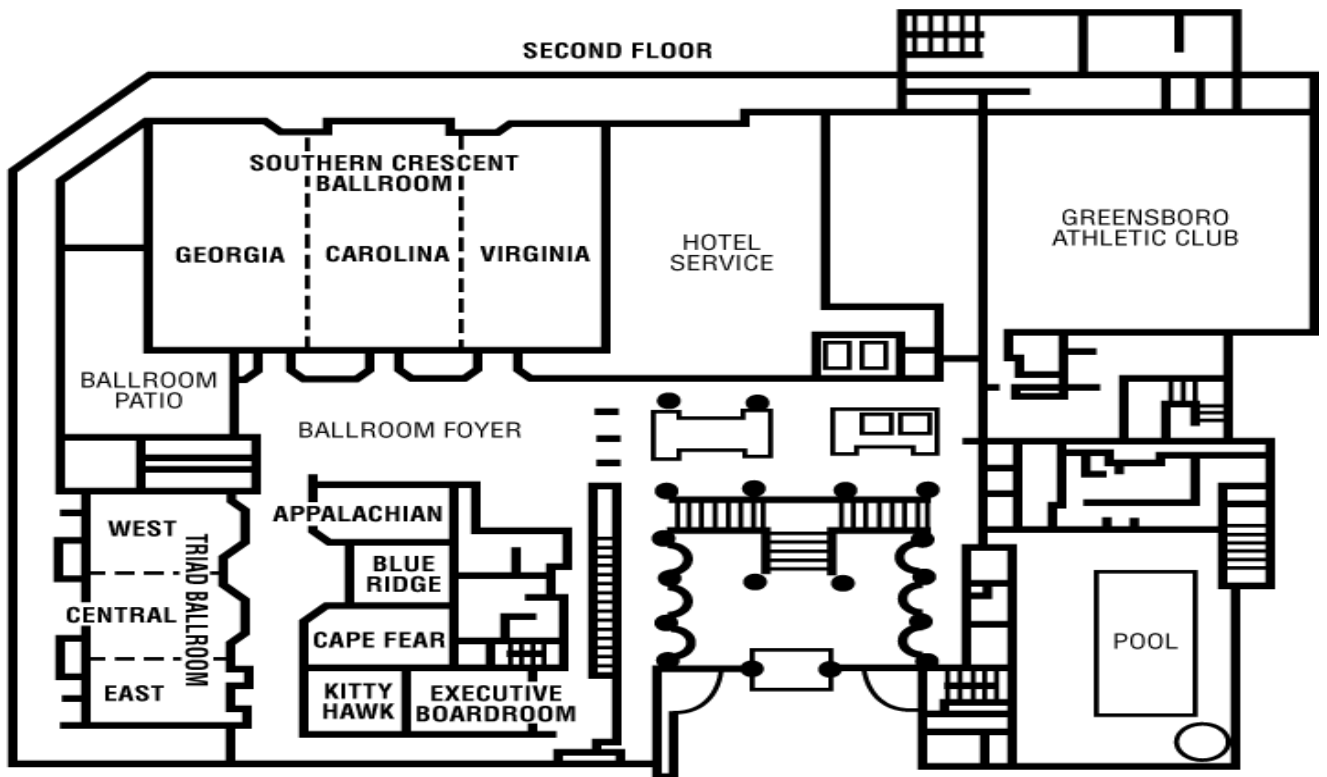

Steering Committee Policy

Southeastern Division of the Association of American Geographers

Adopted, November 1995

NonSmoking Policy

The Southeastern Division of the AAG maintains a nonsmoking policy in all meeting rooms.

Accessibility

In support of the Americans with Disabilities Act, the Southeastern Division of the AAG and its contracted hotel's management make reasonable accommodations to the extent possible when they are requested. Individuals requiring such accommodations are asked to make their needs known to the Local Arrangements Committee as early as possible so every effort can be made to provide the requested accommodations.

Professional Conduct

Professional ideas and information are exchanged most effectively at the Southeastern Division of the AAG's Annual Meeting in an atmosphere free of abuse or harassment and characterized by courtesy and respect. To that end, the Southeastern Division of the AAG expects all individuals who attend to conduct themselves in a manner that establishes an atmosphere free from discriminatory practices and harassment.